

MILLER • DUNWIDDIE • ASSOCIATES • INC.
 3600 WEST 78th STREET • SUITE 850 • MINNEAPOLIS, MN 55425

MINNESOTA STATE CAPITOL

FIRST FLOOR

ORIGINAL PLANS

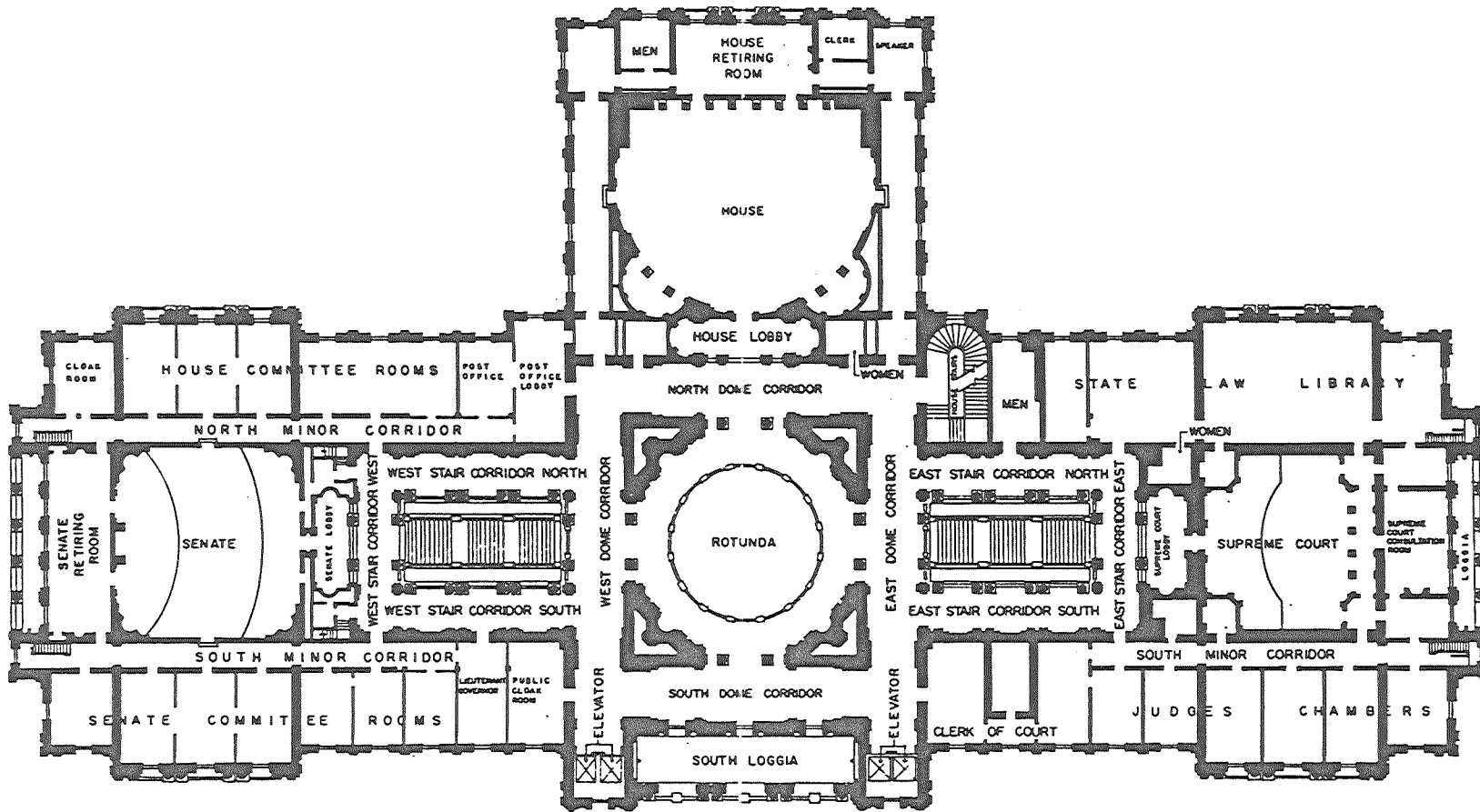

MD

MILLER • DUNWIDDIE • ASSOCIATES • INC
3600 WEST 78th STREET • SUITE 850 • MINNEAPOLIS, MN 55435

MINNESOTA STATE CAPITOL
SECOND FLOOR

ORIGINAL PLANS

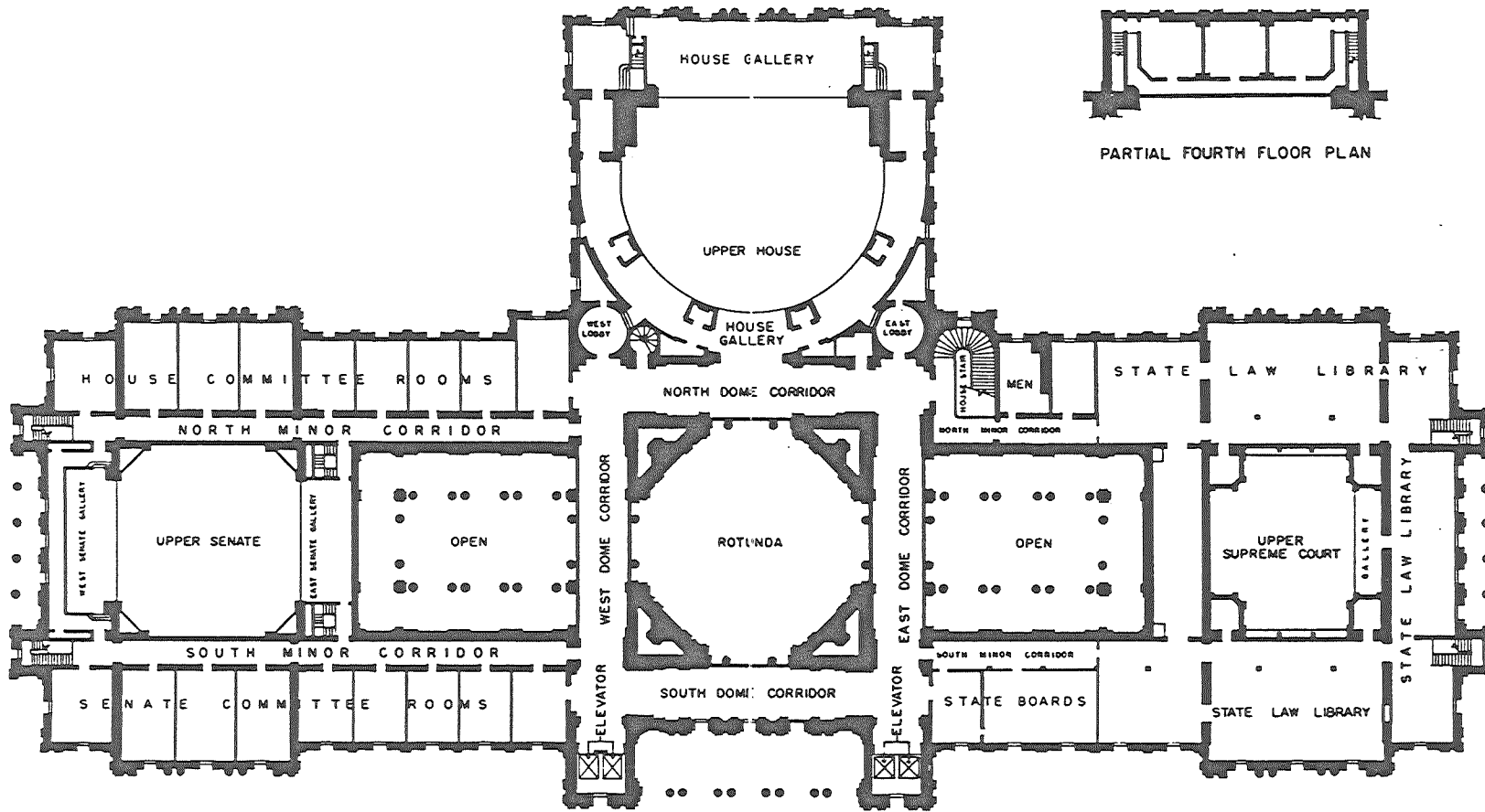

MD

MILLER • DUNWIDDIE • ASSOCIATES • INC
3600 WEST 76TH STREET • SUITE 850 • MINNEAPOLIS, MN 55435

MINNESOTA STATE CAPITOL
THIRD FLOOR

ORIGINAL PLANS

APPENDIX B:

Historic Space Use

These plans show the original 1905 space assignments in the Capitol which have been superimposed on the present-day plans of the building for comparative purposes.

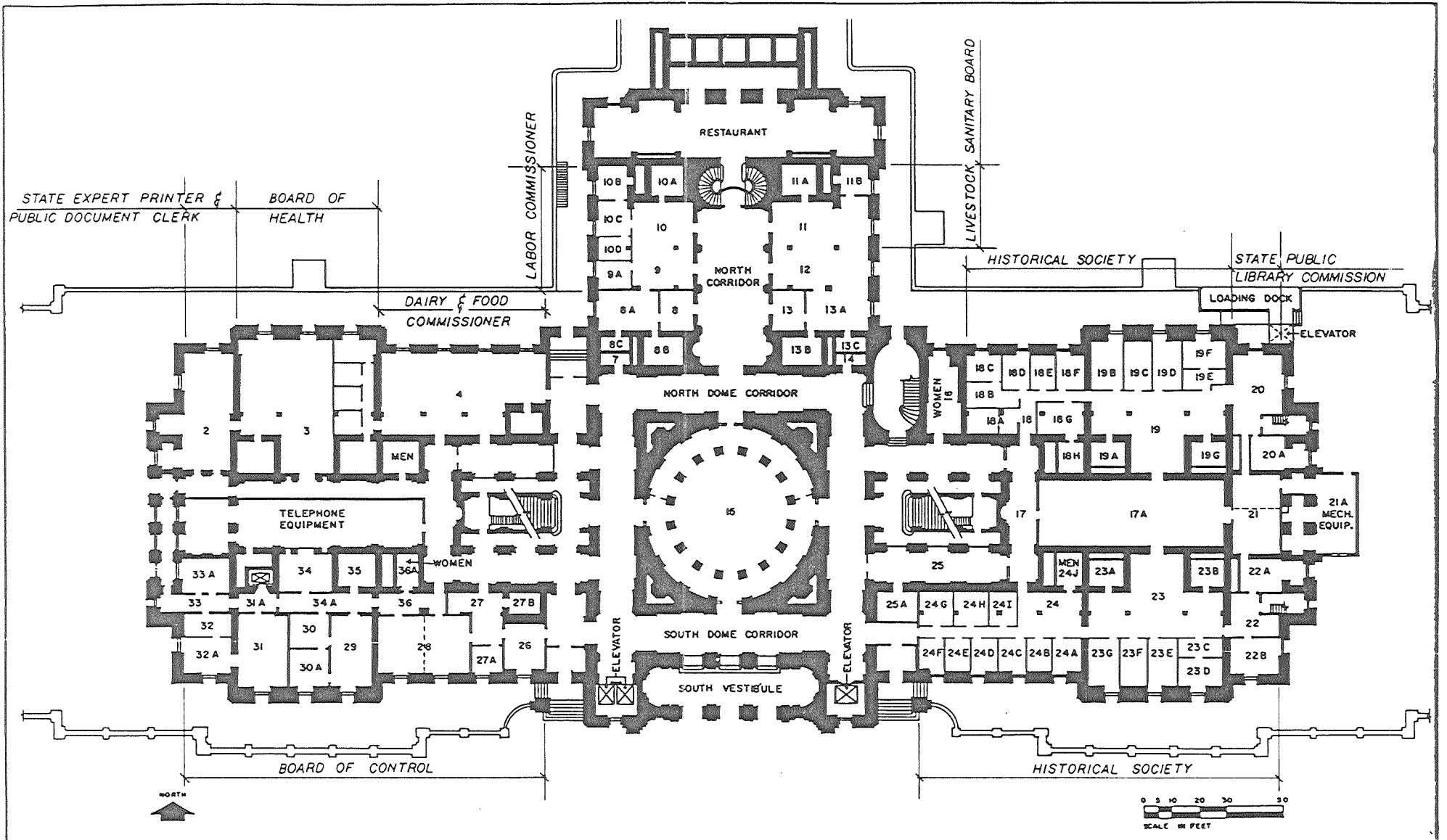

MILLER • DUNWIDDIE • ASSOCIATES • INC.
 3600 WEST 78th STREET • SUITE 850 • MINNEAPOLIS, MN 55435

MINNESOTA STATE CAPITOL GROUND FLOOR

HISTORIC SPACE USE

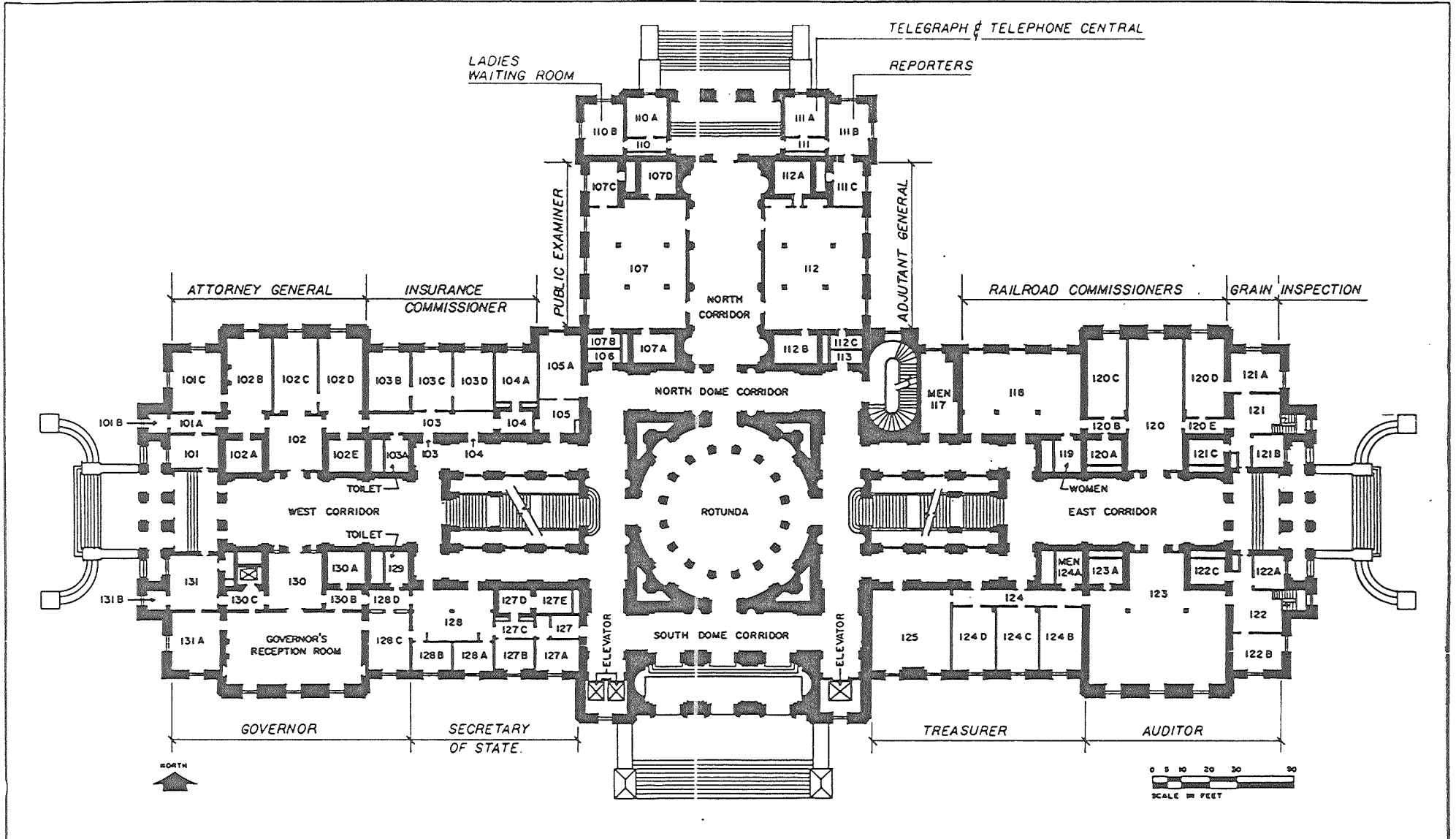

MILLER • DUNWIDDIE • ASSOCIATES • INC.
 3600 WEST 78TH STREET • SUITE 850 • MINNEAPOLIS, MN 55435

MINNESOTA STATE CAPITOL

FIRST FLOOR

HISTORIC SPACE USE

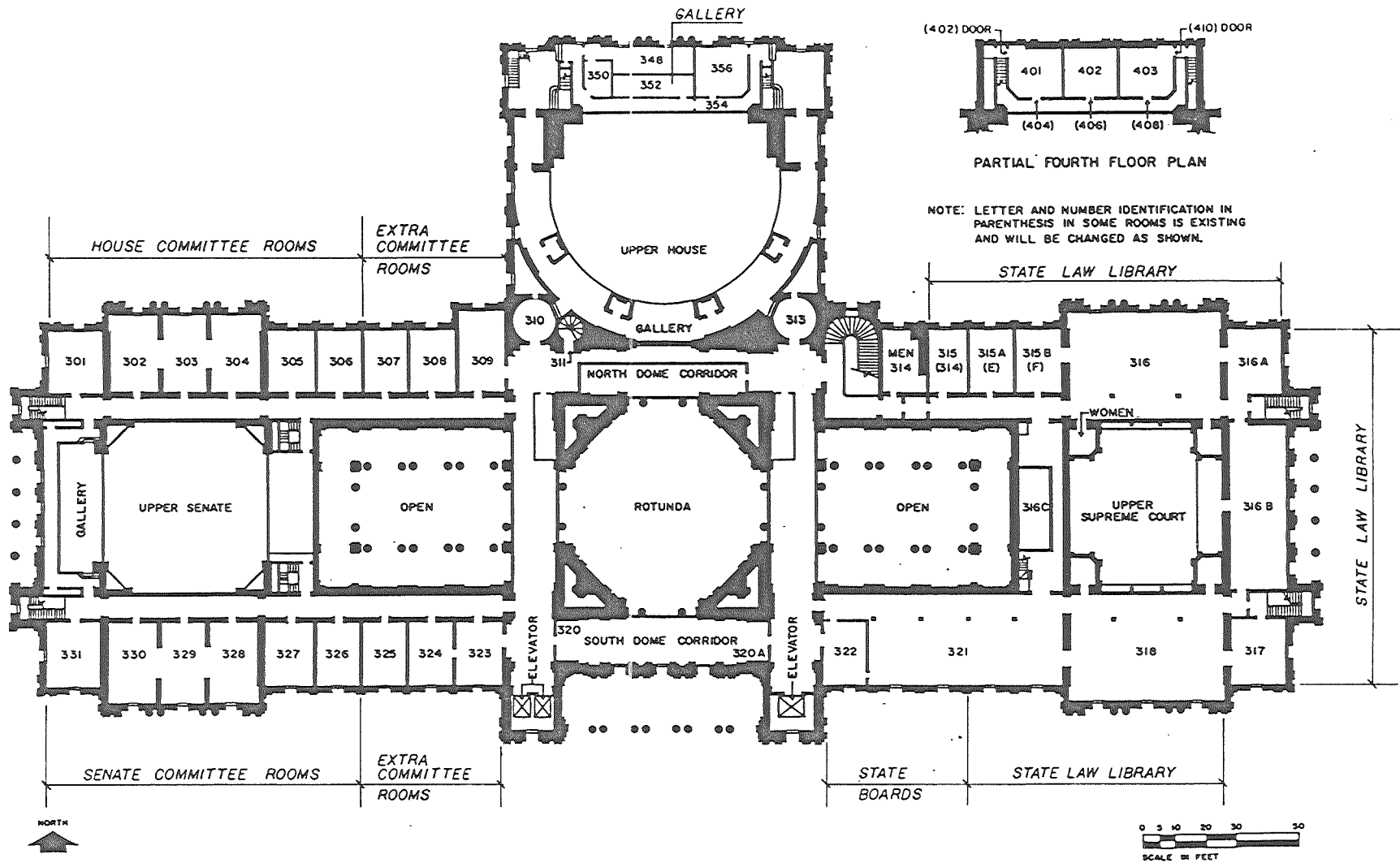

MILLER • DUNWIDDIE • ASSOCIATES • INC.
 3600 WEST 78th STREET • SUITE 850 • MINNEAPOLIS, MN 55435

MINNESOTA STATE CAPITOL THIRD FLOOR







HISTORIC SPACE USE

APPENDIX C:

Existing Space Use

These plans show the present-day configuration of the Capitol building. The various shaded areas illustrate the existing space assignments within the building.

SPACE DESIGNATION

- | | |
|--|---|
|  GOVERNOR |  REVISOR OF STATUTES |
|  SENATE |  LEGISLATIVE LIBRARY |
|  HOUSE |  PLANT MGT. |
|  LT. GOVERNOR | |

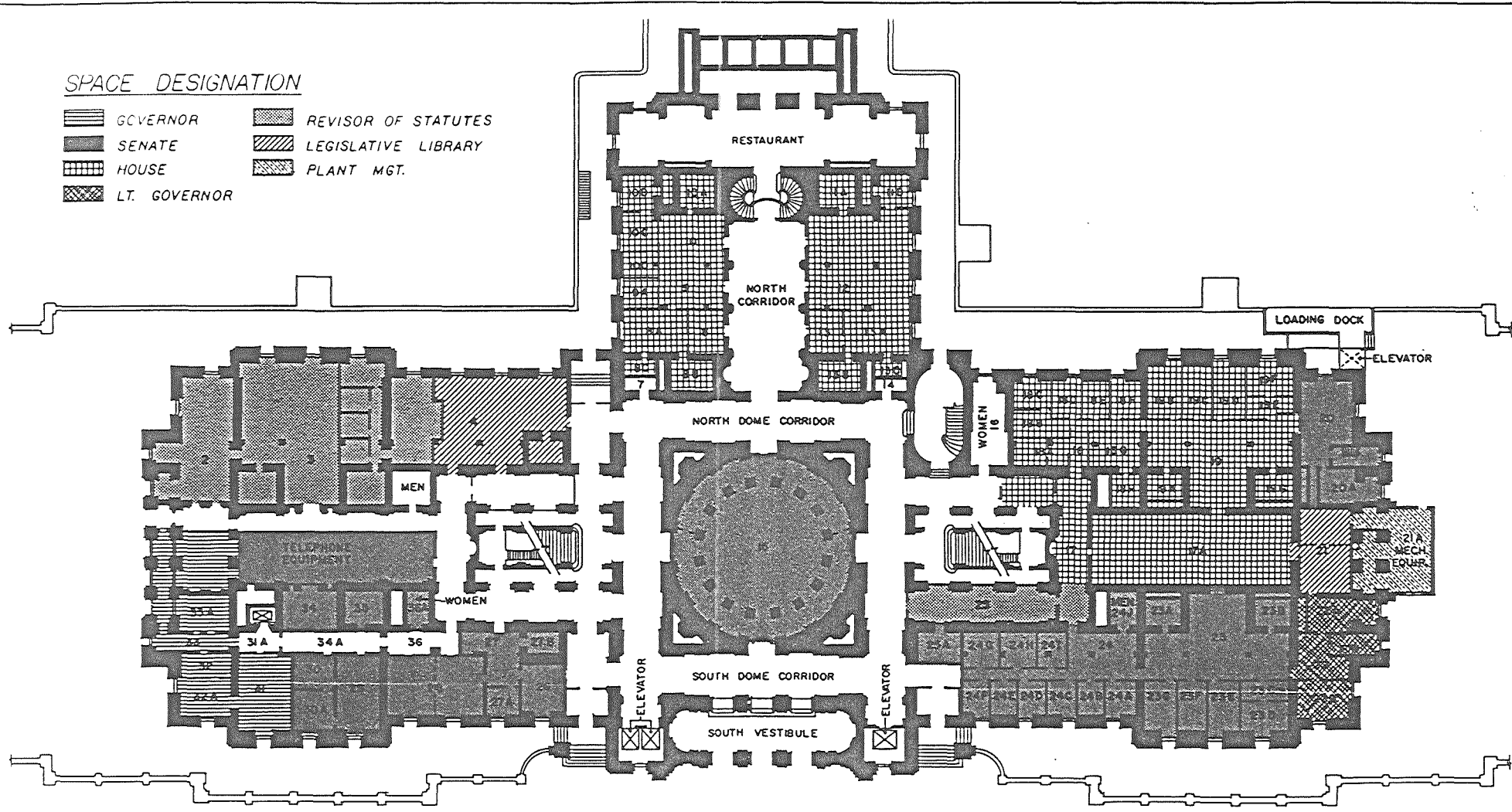

MILLER • DUNWIDDIE • ASSOCIATES • INC.
 3600 WEST 78th STREET • SUITE 850 • MINNEAPOLIS, MN 55435

MINNESOTA STATE CAPITOL
 GROUND FLOOR

EXISTING SPACE USE

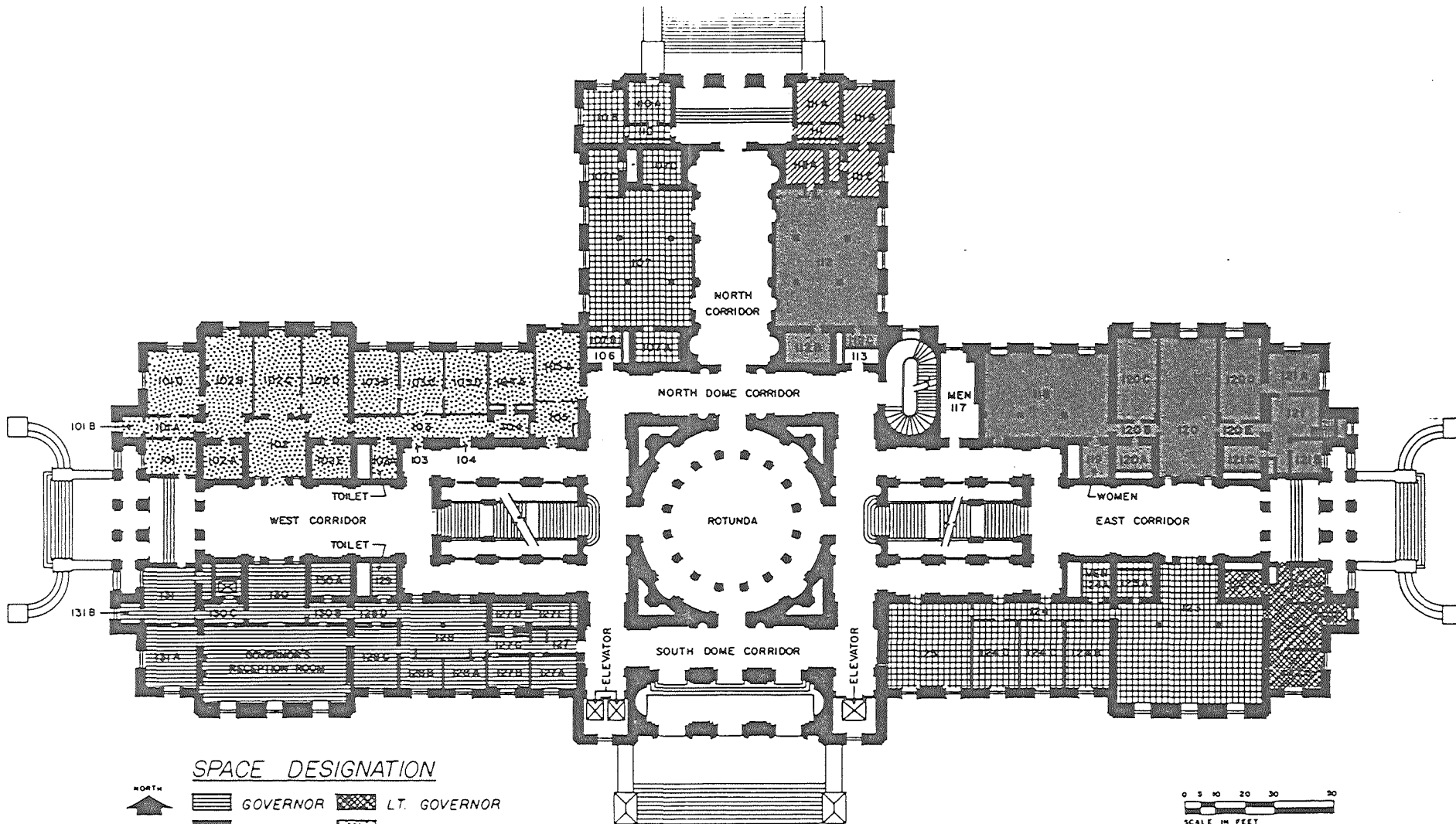

SPACE DESIGNATION



- | | | | |
|--|----------|--|---------------------|
| | GOVERNOR | | LT. GOVERNOR |
| | SENATE | | ATTORNEY GENERAL |
| | HOUSE | | LEGISLATIVE LIBRARY |



MILLER • DUNWIDDIE • ASSOCIATES • INC
 1600 WEST 78th STREET • SUITE 850 • MINNEAPOLIS, MN 55435

MINNESOTA STATE CAPITOL
 FIRST FLOOR

EXISTING SPACE USE

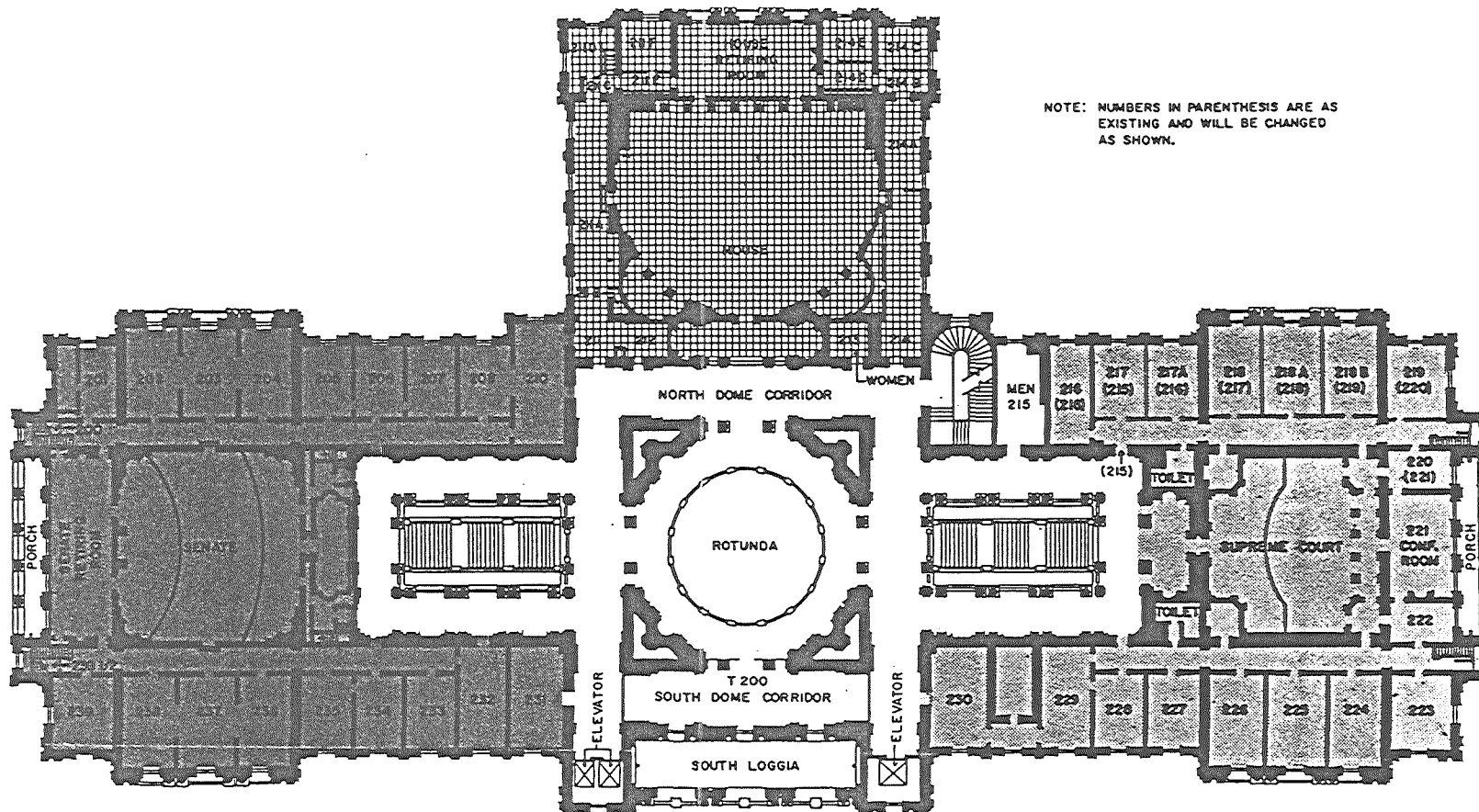

NOTE: NUMBERS IN PARENTHESIS ARE AS EXISTING AND WILL BE CHANGED AS SHOWN.

SPACE DESIGNATION



-  SENATE
-  HOUSE
-  SUPREME COURT

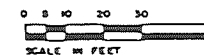

MILLER • DUNWIDDIE • ASSOCIATES • INC.
3600 WEST 78th STREET • SUITE 850 • MINNEAPOLIS, MN 55435

MINNESOTA STATE CAPITOL
SECOND FLOOR

EXISTING SPACE USE

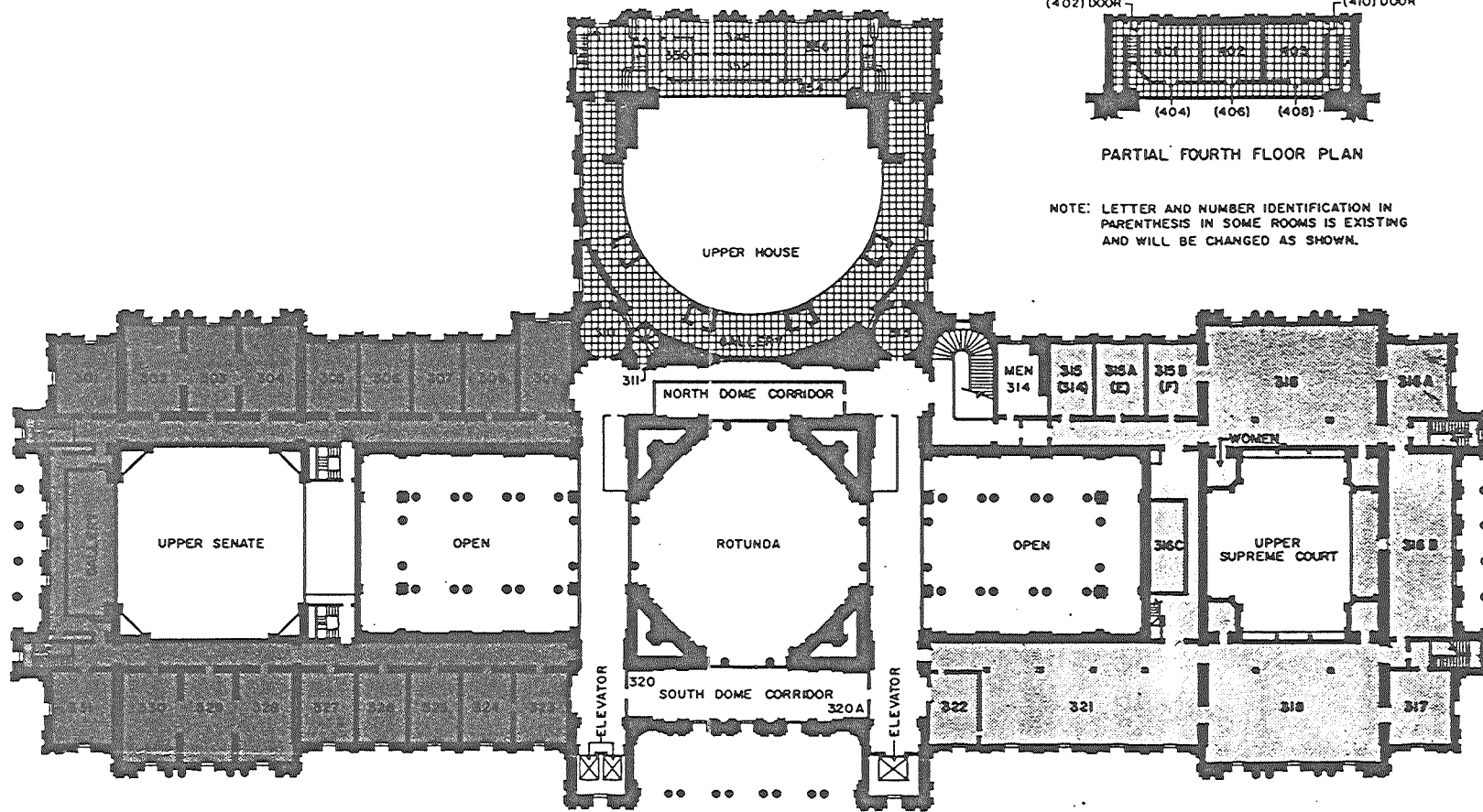

SPACE DESIGNATION



-  SENATE
-  HOUSE
-  SUPREME COURT

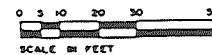

MILLER • DUNWIDDIE • ASSOCIATES • INC.
3600 WEST 78th STREET • SUITE 850 • MINNEAPOLIS, MN 55435

MINNESOTA STATE CAPITOL
THIRD FLOOR

EXISTING SPACE USE

APPENDIX D:

Public and Ceremonial Areas

These plans show the present-day configuration of the Capitol building. The shaded areas represent the original Public and Ceremonial Areas and the newly created Public Hearing Rooms within the building that have been considered in this study.

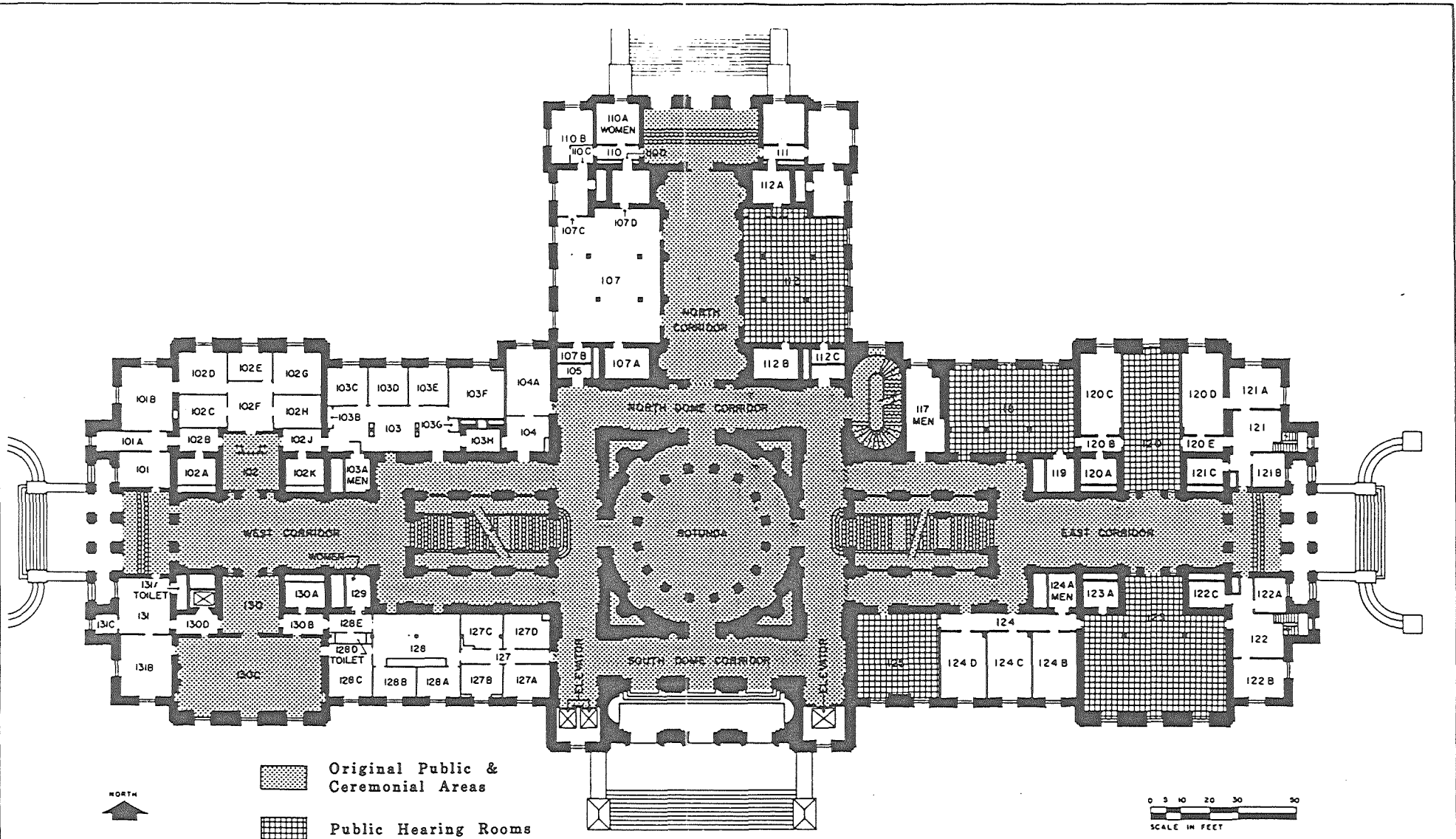



MILLER • DUNWIDDIE • ASSOCIATES • INC.
3600 WEST 78th STREET • SUITE 850 • MINNEAPOLIS, MN 55435

MINNESOTA STATE CAPITOL

FIRST FLOOR

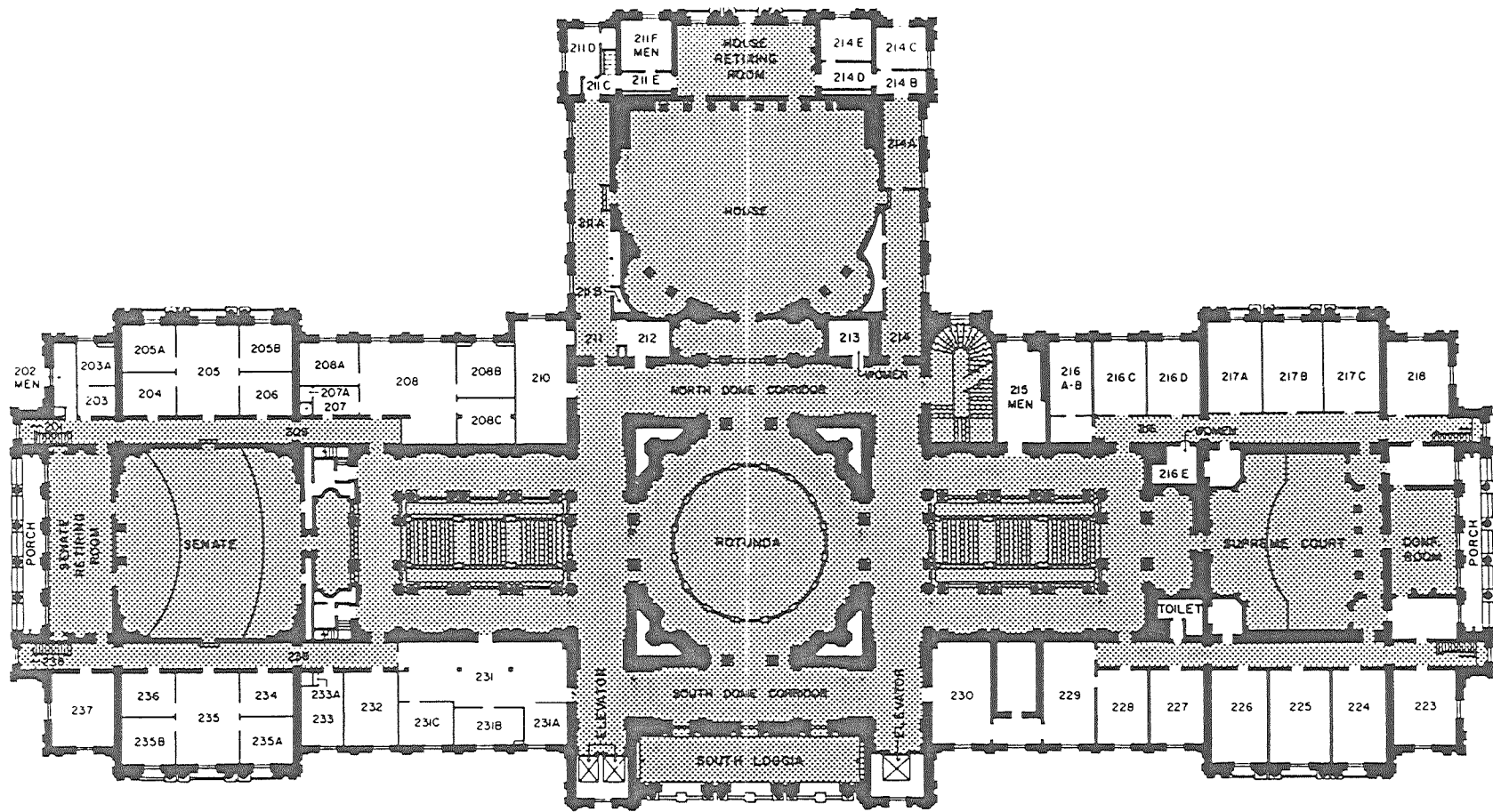
PUBLIC & CEREMONIAL
SPACES



 Original Public & Ceremonial Areas





MILLER • DUNWIDDIE • ASSOCIATES • INC.
3600 WEST 78th STREET • SUITE 850 • MINNEAPOLIS, MN 55435

MINNESOTA STATE CAPITOL SECOND FLOOR

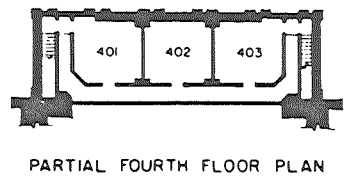
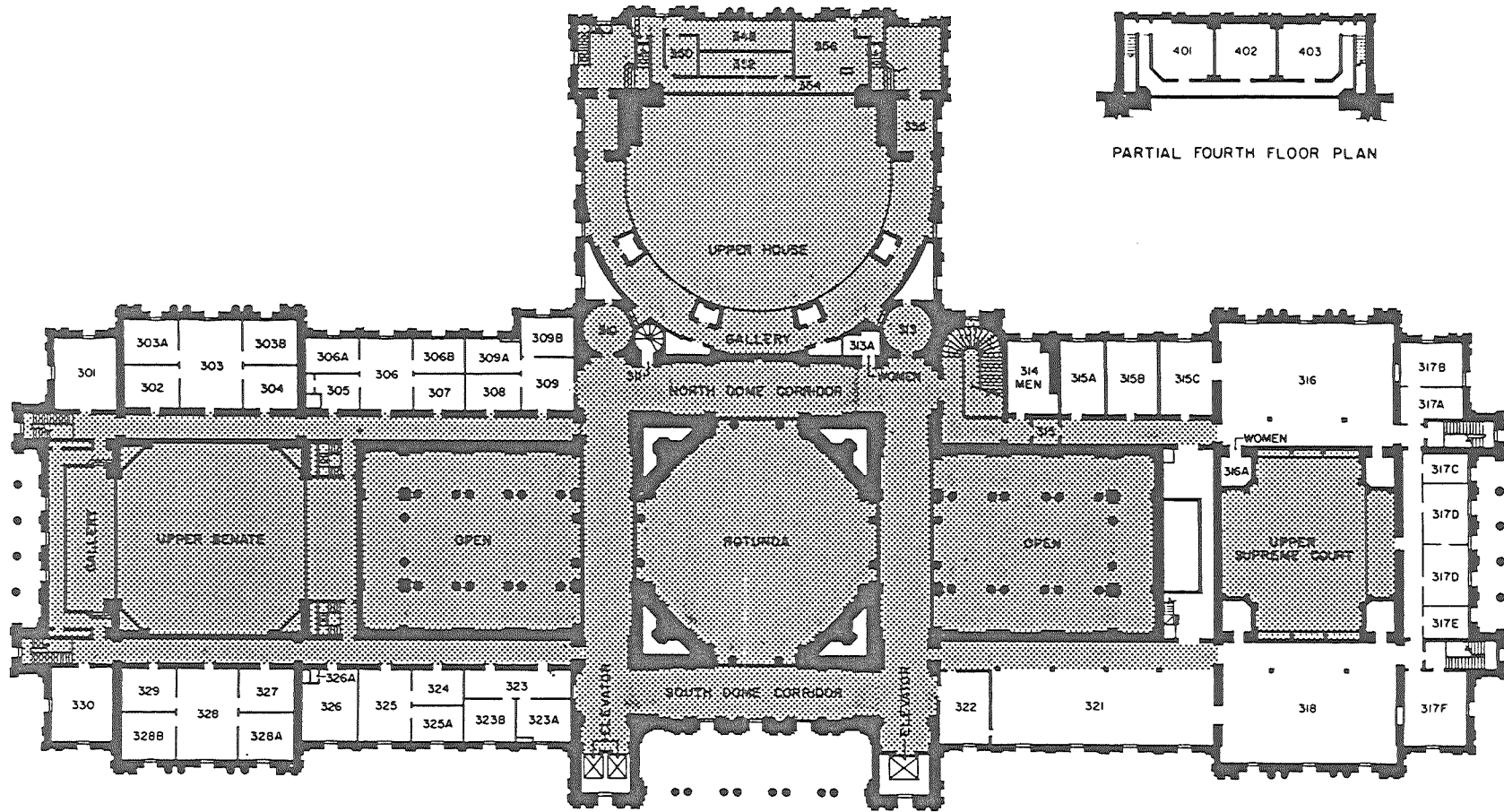
PUBLIC & CEREMONIAL
SPACES





 Original Public & Ceremonial Areas

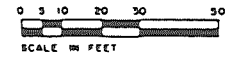

MD MILLER • DUNWIDDIE • ASSOCIATES • INC.
 3600 WEST 78th STREET • SUITE 850 • MINNEAPOLIS, MN 55435

MINNESOTA STATE CAPITOL
THIRD FLOOR

PUBLIC & CEREMONIAL SPACES